

# Marex ECS

## Designed to keep the course





## Design by Rexroth – pairing form with function.

Excellent design supports operation in all situations. The straightforward, timeless style of the Marex ECS goes well with any ship design. Unmistakable keypad icons ensure intuitive operation.

- ▶ Exclusive chrome surfaces, contrasted with black
- ▶ Language-independent icons
- ▶ Subtle backlight illumination
- ▶ Dynamic, asymmetric levers



# Marex ECS

## The Easy Control System.

Easy to operate with a unique design and extensive options: the Marex ECS meets the highest production and quality standards and provides captains with maximum reliability, as proven by endurance testing with one million lever actuations. The Marex ECS controls single or twin gasoline and diesel engine applications from up to four control stations. Trolling gear control is available as an option. The system is designed for small pleasure and work boats and is

compatible with all common engine types and reversing gears. Its hardware originates from proven automotive applications. The well-established CAN bus technology ensures reliable communication between the components. Sophisticated auto-diagnostics inform the operator of the current operating state. An alarm log is provided for subsequent evaluation.

### Advantages

- ✓ Unique, timeless design
- ✓ Wi-Fi web server
- ✓ Proven BOSCH components

#### Design

- ▶ Timeless
- ▶ Easy to integrate
- ▶ With backlight illumination



#### User experience

- ▶ Wi-Fi web server
- ▶ Auto-config
- ▶ Language-independent icons



#### Safety

- ▶ Proven BOSCH components
- ▶ ABYC-compliant
- ▶ Backup Hall sensor





# User-friendly – extensive experience combined with state-of-the-art technology.

With the Marex Easy Control System, Rexroth Pneumatics is introducing one of the most innovative engine remote controls with integrated Wi-Fi to the market. Its sophisticated technology combines complex functionality with easy handling resulting in reduced installation and commissioning efforts and uncomplicated operation features. It can be adjusted wirelessly via Wi-Fi without additional software and hardware adapters, using the standard web browser on any smartphone, tablet, or laptop. The guiding browser interface ensures smooth commissioning.

- ▶ Market innovation: integrated Wi-Fi
- ▶ Web server access independent of hardware and operating system
- ▶ Auto-configuration
- ▶ Plug-in solution
- ▶ Ergonomic keypad design

## Time-saving start-up

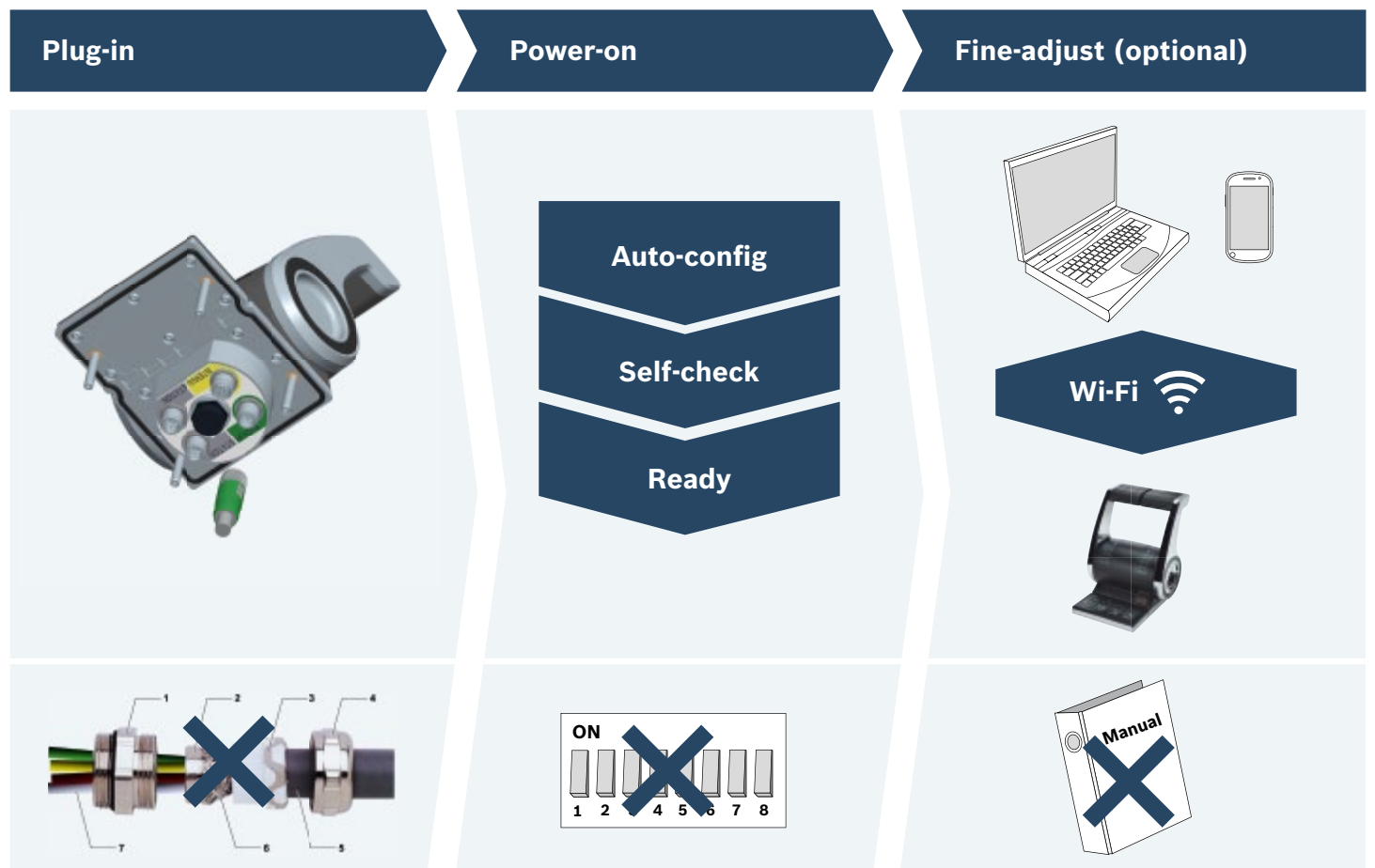



# Reliable – in all waters, for every maneuver.

## Basic

Reliability made in Germany. Even the basic version of the Marex ECS sets benchmarks with its dependable function and meets the highest BOSCH production and quality standards. All components were developed in accordance with ABYC specifications and feature optimized safety in terms of electromagnetic radiation and environmental compatibility.

- ▶ Proven BOSCH control unit
- ▶ Sophisticated BOSCH actuator
- ▶ ABYC-compliant
- ▶ Alarm log
- ▶ Manual operation of actuator
- ▶ Engine stall protection

## ABYC-compliant

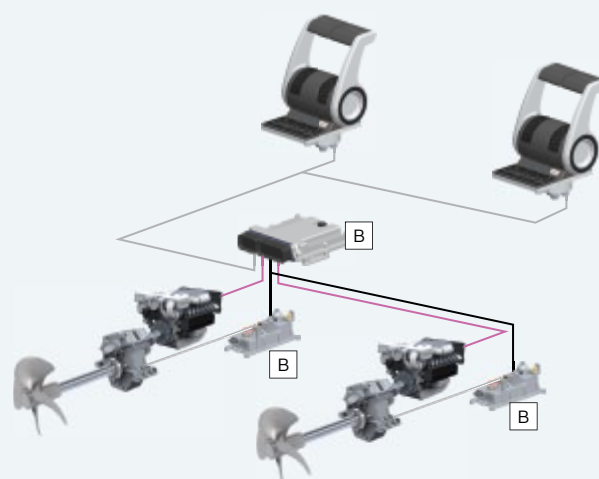

B | BOSCH components

## Enhanced

The enhanced Marex ECS system features a separate backup Hall sensor which makes it even more reliable and safe. The control of the boat will be maintained, even if CAN communication is interrupted. In this version, each main propulsion is equipped with its own Marex ECS control – ensuring top-fail performance and system availability.

## Additional functions exceeding basic version

- ▶ Backup Hall sensor
- ▶ One control per propulsion
- ▶ Gear feedback monitoring

## Back-up Hall sensor

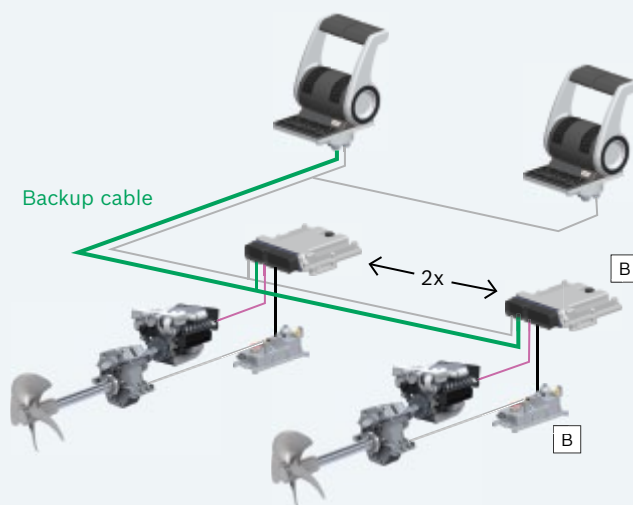

**Bosch Rexroth Pneumatics GmbH**

Marine

Ulmer Straße 4

30880 Laatzen, Germany

PO Box 110161

30856 Laatzen, Germany

Phone +49 511 2136-251

Fax +49 511 2136-165

[marinesales@rexrothpneumatics.com](mailto:marinesales@rexrothpneumatics.com)

[www.marex-shipcontrols.com](http://www.marex-shipcontrols.com)

Your Contact:

